

INSTALLATION INSTRUCTIONS #39717

Please read carefully and save these instructions, as you may need them at a later date.

CAUTION

WARNING: Risk of Fire. Consult a qualified electrician to ensure correct branch circuit conductor. Min 90°C supply conductors.

Turn off the main power at the circuit breaker before installing the fixture, in order to prevent possible shock.

GENERAL

All electrical connections must be in accordance with local and National Electrical Code (N.E.C.) standards. If you are unfamiliar with proper electrical wiring connections obtain the services of a qualified electrician.

Remove the fixture and the mounting package from the box and make sure that no parts are missing by referencing the illustrations on the installation instructions.

ASSEMBLY AND INSTALLATION

1. Pull out the outlet wire and ground wire from the pole(15). Make wire connections
--White wire (w/o marking) from light to White wire(11) from power source.
--Black wire (w/o marking) from light to Black wire(12) from power source.
--Loop the Ground wire(13) to pole(15) with wire connector(14).
2. Install bulbs: (bulbs not included)
(Do not exceed the maximum capacity recommended on the sockets).
3. Put the glass shade(5), cover (4), cap(3), rubber washer (2) onto nipple (6)
one by one, then secure it with finial(1).

INSTALLATION IS NOW COMPLETED

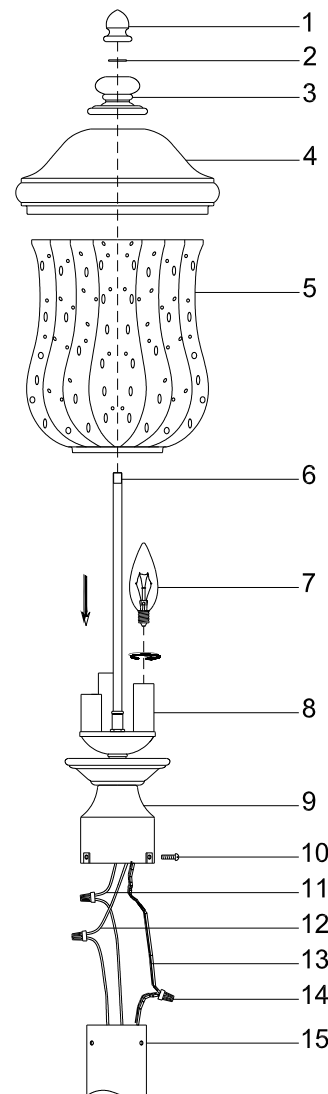

1. FINIAL
2. RUBBER WASHER
3. CAP
4. COVER
5. GLASS SHADE
6. NIPPLE
7. BULB
8. SOCKET
9. POST ADAPTER
10. MOUNTING SCREW
11. WHITE WIRE
12. BLACK WIRE
13. GROUND WIRE
14. WIRE CONNECTOR
15. POLE